

UBER

Advanced
Technologies
Group

PUZZLE CUBE

Service Manual

Revision A

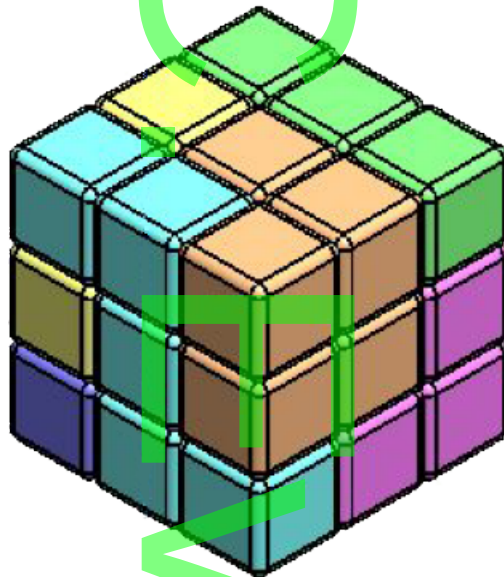

Part Number: 10056916A Size: A

Uber Advanced Technologies Group
100 32nd Street
Pittsburgh, PA 15201
info@uberatg.com
<https://www.uber.com/info/atg/>

Overview

The Uber Puzzle Cube is a construction of six pieces that, when properly assembled, form a cube. Each piece is an arrangement of 3, 4, or 5 smaller cubes that together form a 3 small cube by 3 small cube by 3 small cube construction. Within each component piece, the smaller cubes are attached permanently to each other in an arrangement that is unique within the Puzzle Cube. Each piece also has a unique color within the Puzzle Cube, making it convenient to refer to the pieces by color name.

This manual provides an introduction to the Puzzle Cube, its component parts, service instructions, and troubleshooting guidance.

Parts List

The main Puzzle Cube assembly contains six parts as follows:

Item No.	Part Number	Revision	Description	Qty.	Manufacturer	Manufacturer Part Number
1	10056913		Blue Cubes	1	UATC	NA
2	10056914		Orange Cubes	1	UATC	NA
3	10056915		Purple Cubes	1	UATC	NA
4	10056917		Yellow Cubes	1	UATC	NA
5	10159618	A	Green Cubes	1	UATC	NA
6	10056919		Pink Cubes	1	UATC	NA

Note: The original version of this product included Green Cubes part number 10056918. This part is subject to a recall detailed in the Technical Bulletin. Inspect all Puzzle Cubes during service to determine if the recall service has been performed which replaces Green Cubes part number 10056918 with Green Cubes part number 10159618.

If this replacement has not been performed, advise the customer to discontinue use until the replacement can be performed. See the Service Instructions in this manual for “Green Cubes Recall Service” instructions.



Part Descriptions

To understand the composition of the Puzzle Cube, familiarize yourself with the 6 parts that are assembled to form the larger cube. The color name of each part is vital to understanding the assembly of the Puzzle Cube. If you have difficulty seeing color, you will need to learn the shape of each part and associate it with the color name of each part.

Blue Cubes (PN: 10056913)

The Blue Cubes part is an arrangement of 5 small cubes in a coplanar Z shape. In the final assembly, the Blue Cubes occupy five of the nine spaces in the left front face of the Puzzle Cube.

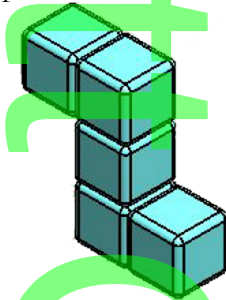

Orange Cubes (PN: 10056914)

The Orange Cubes part is an arrangement of 5 small cubes. Four of them form a square, and the fifth protrudes from the back of the part. This protruding small cube occupies the center of the top face of the cube in the final assembly. The square of cubes occupies four of the nine spaces in the front right face of the Puzzle Cube.

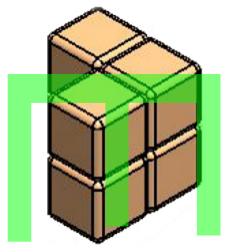

Purple Cubes (PN: 10056915)

The Purple Cubes part is an arrangement of 5 small cubes. Four of the cubes are coplanar in a Z shape, and the fifth protrudes upwards from the top of the part. This protruding cube occupies the very center of the Puzzle Cube in the final assembly. The other four cubes occupy four of the five spaces in the bottom face of the cube.

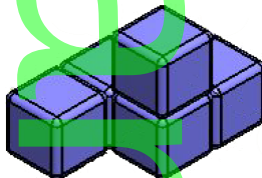

Yellow Cubes (PN: 10056917)

The Yellow Cubes part is an arrangement of 5 small cubes. All five of the cubes are coplanar. In the final assembly, the Yellow Cubes occupy five of the nine spaces in the left rear face of the Puzzle Cube.

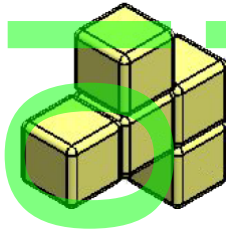

Green Cubes (PN: 10159618)

The Green Cubes part is an arrangement of 3 small cubes. All three cubes are in a straight line. This line occupies the top edge of the right rear face.

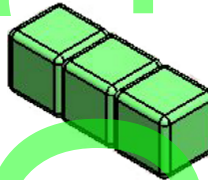

Note: The original version of this product included Green Cubes part number 10056918. this part is subject to a recall detailed in the Technical Bulletin. Inspect all Puzzle Cubes during service to determine if the recall service has been performed which replaces Green Cubes part number 10056918 with Green Cubes part number 10159618.

Pink Cubes (PN: 10056919)

The Pink Cubes part is an arrangement of 4 small cubes. The cubes are paired into two skewed lines. In the final assembly, three of the four cubes occupy the lower right corner of the right front face of the Puzzle Cube. The fourth small cube occupies the center of the right rear face.

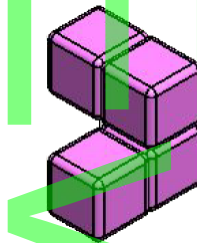

Service Instructions

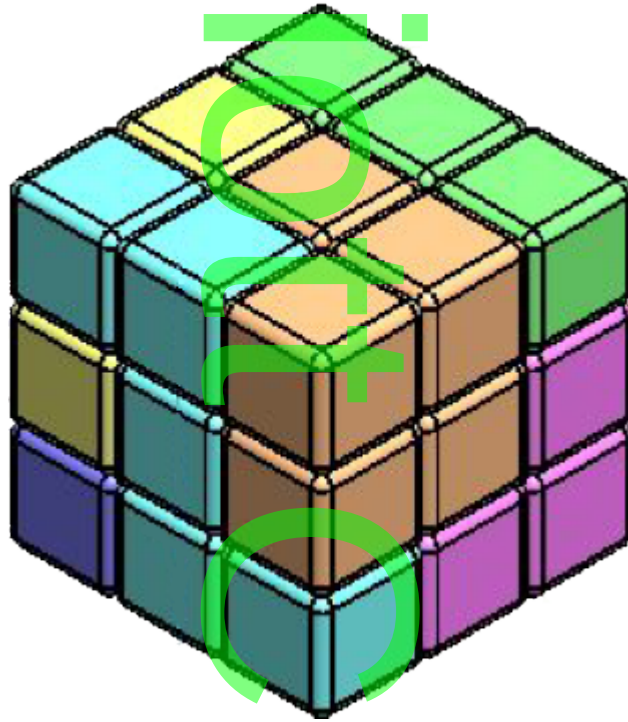

Maintenance

The Puzzle Cube is molded from a durable material and requires very little maintenance. If the parts become soiled, clean the affected part(s) with a soft, damp cloth. Do not use harsh chemicals or abrasives.

If a part becomes damaged or has deteriorated, replace the affected part with a new part. Refer to the Parts List in this manual for individual part numbers for each component piece. Replace parts only with official UATC parts.

Disassembly Instructions

The component pieces of the Puzzle Cube are not fastened together in any way. To disassemble the cube, grasp each piece in turn and remove it from the assembly. To aid in re-assembly, take note of the orientation of each piece and its relation to the others. Do not use any tools to disassemble the Puzzle Cube, as tools may damage the material of the component pieces.

Assembly Instructions

The component pieces of the Puzzle Cube can be assembled in several combinations and shapes, as well as in multiple orientations. The combination and orientation described below is the only approved possibility. Do not assemble the Puzzle Cube in any other orientation or shape as this constitutes a violation of the warranty.

1. To begin, arrange the component pieces in your workspace into the orientations shown. This will place them in the orientations they occupy in the final assembly and aid in the assembly process.

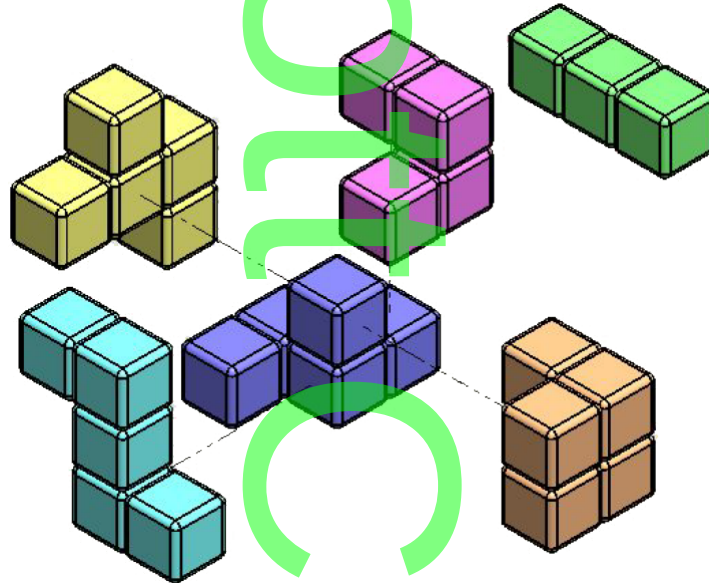

2. Place the Purple Cubes in the center of the work space. The small cube that protrudes upwards will occupy the very center of the final assembly.
3. Place the Yellow Cubes along the back edge of the Purple Cubes with the downward-pointing small cube in the rear bottom corner of the assembly.
4. Place the Pink Cubes to the right front of the Purple Cubes so that the protruding small cube is resting on the Purple Cubes.
5. Place the Blue Cubes at the left front of the assembly such that the upper small cube that protrudes from the back of the piece is resting on the Yellow Cubes. Note that two orientations of the Blue Cubes yield the required alignment. Either is acceptable.
6. Place the Orange Cubes in the assembly such that the small cube that protrudes backwards from the square face is resting on the Purple Cubes.
7. Complete assembly by placing the Green Cubes along the rear upper right edge of the Puzzle Cube. Note that eight orientations of the Green Cubes yield the required alignment. Any is acceptable.
8. Slide all parts gently together to remove any small alignment gaps between pieces.

The final assembly of the Puzzle Cube should form a 3 by 3 by 3 solid cube with no gaps and no protruding small cubes.

Green Cubes Recall Service

The original version of this product included Green Cubes part number 10056918. Some types of use may cause the **Green Cubes** part (Number: 10056918) to delaminate. This delamination causes friction if use continues. The friction will produce excessive heat. Heat build-up will cause **serious risk of fire**.

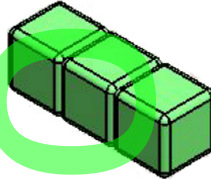

Inspect all Puzzle Cubes during service to determine if the recall service has been performed which replaces Green Cubes part number 10056918 with Green Cubes part number 10159618. **Discontinue all use** until part replacement service is performed.

1. Disassemble Puzzle Cube according to Disassembly Instructions above.
2. Remove Green Cubes part number 10056918.
3. Return Green Cubes part number 10056918 to UATG for full credit.
4. Replace with revised Green Cubes part number 10159618.
5. Assemble Puzzle Cube according to Assembly Instructions above.

All recall service of eligible cubes should be performed under labor number 201701.

Troubleshooting

Assembled Puzzle Cube has protruding small cubes.

Parts were not in proper alignment during assembly. Disassemble the puzzle cube and re-assemble with the component pieces in the proper alignment.

Assembled Puzzle Cube has gaps.

Small surface gaps often occur during assembly. Slide all parts gently together to remove any small alignment gaps between pieces.

Large gaps are the result of missing or incorrect component pieces. Disassemble the Puzzle Cube and check the component pieces against the parts list and Part Descriptions. Identify which pieces are missing and contact UATC for replacement parts.

Pieces will not slide together.

One or more pieces are incorrect or damaged. Disassemble the Puzzle Cube and check the component pieces against the parts list and Part Descriptions. Identify which pieces are missing and contact UATC for replacement parts.

If all pieces are correct, inspect each piece for damage or has deterioration, and replace the affected part with a new part. Refer to the Parts List in this manual for individual part numbers for each component piece. Replace parts only with official UATC parts.

Puzzle Cube heats during use.

Some types of use may cause the **Green Cubes** part (Number: 1005918) to delaminate. This delamination causes friction if use continues. The friction will produce excessive heat. Heat build-up will cause **serious risk of fire**.

Discontinue all use until part replacement service is performed. See the Service Instructions in this manual for “Green Cubes Recall Service” instructions.

